

1.

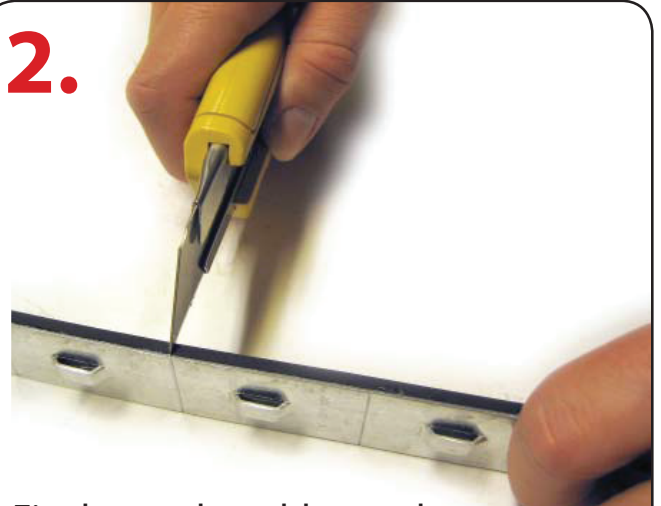

Use a carpet knife or similar for the cutting.

2.



Firstly, cut the rubber at the separation groove.

3.

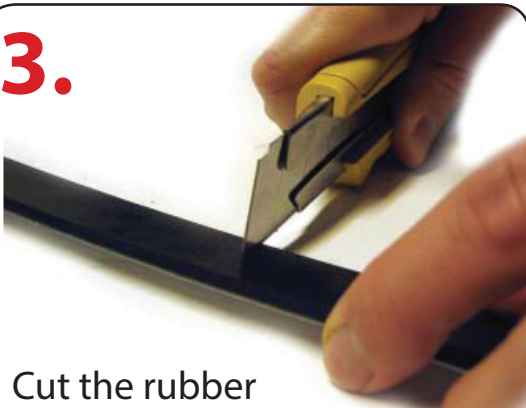

Cut the rubber completely at the same line.

4.

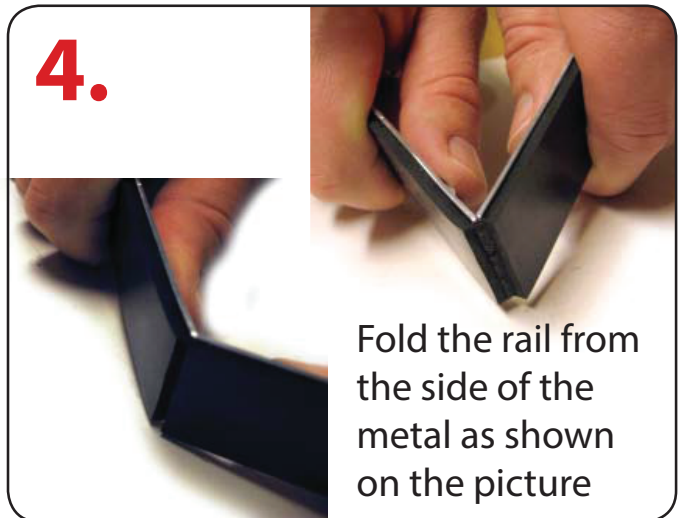

Fold the rail from the side of the metal as shown on the picture

5.

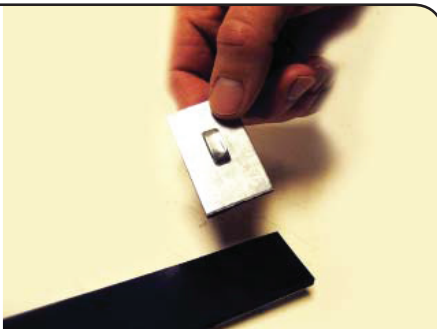

The rail breaks easily on the right place

What you need to attach the Cable Rail: Cleaner - Loctite N° 7063, Glue - Loctite N° 435 and dry cloth

How to attach it:

1. Spray the cleaning agent on both surfaces (to be glued) and rub the surfaces clean with a cloth.
2. Spray the cleaner again on both surfaces and let it evaporate to dry.
3. Apply a thin stripes of glue to the surfaces and press together.

Using too much glue prevents hardening!